

For a complete offering of OE specific tools, go to <http://toolsfortrucks.spx.com/>

HOME | ABOUT SPX | HOW TO ORDER | ORDER FORM | WARRANTY | VIEW CART

# SPX | Tools FOR Trucks

SERVICE SOLUTIONS

DETROIT DIESEL  
NAVISTAR  
ALLISON  
VOLVO MACK  
OTC HEAVY DUTY

## MAXIMUM VEHICLE UPTIME

SPX Corporation manufactures tools and equipment for service professionals, making vehicle repairs easier and faster. Specialty Service Tools are available for all applications and vehicles.

PRODUCT SEARCH  
BY PART NUMBER  
BY KEYWORD

PRODUCT SHOPPING CART  
VIEW



### Heavy-Duty Universal Joint Puller

*The ideal tool for disassembling drivelines...*

- May be used with up to a one-inch impact wrench.
- Quickly and easily removes sealed U-joint cups without the need for hammering or heat.
- Will not damage the driveshaft, yoke, bearing cups, or joints. Fits practically all Class 7 and 8 trucks, including: Spicer drivelines 1610, 1710, 1760, 1810, 1880 Spicer SPL 140, 170, and 250 "Life Series" Meritor (Rockwell) 16N, 17N, 18N, 1710 Meritor RPL 20 and 25 "Permalube" Series.

**No. 5190** Heavy-Duty Universal Joint Puller.



Note: For sale in U.S.A only.

### U-Joint Tool

Designed for a 1/2" impact wrench, this U-joint tool removes even the most stubborn U-joints with ease. It's compact and easily set up, making it ideal for service calls. And it can be used at different angles and in tight places, eliminating those damaging makeshift methods. The puller's legs have holes for bolt storage.

- Bolts included: 5/16"-24 x 1-1/2", 3/8"-24 x 1-1/2", 7/16"-20 x 1-1/2", M8-1.25 mm x 35 mm.
- Works on most Dana Spicer and Meritor U-joints - except Spicer's Life series model SPL250X.

**No. 7490** U-joint tool.



### Heavy-Duty Bearing Cup Installer

Quickly and easily installs bearing cups on Dana/Spicer SPL "Life Series" quick-disconnect universal joints.

- Three individual adapters press bearings to the manufacturer's recommended depths.
- Adapters fit Spicer SPL 140, 170, and 250 series drivelines.

**No. 5191** Heavy-Duty Bearing Cup Installer.



### Pilot Bearing Pullers

These tools make quick work of pulling stubborn, rusted pilot bearings. No. 5048 fits 1-1/4" I.D. bearings, and No. 5049 fits 1" I.D. bearings. The puller's forcing screw expands the jaws inside the bearing and simultaneously pushes against the crankshaft.

**No. 5048** Pilot bearing puller for 1-1/4" I.D.

**No. 5049** Pilot bearing puller for 1" I.D.



### Heavy-Duty Bearing Cup Installer

Quickly and easily installs bearing cups on bolt-retained universal joints. Fits series 1610 to 1880 and nearly all other heavy-duty truck and machine type u-joints with bolt-retained bearing cups.

- Automatically aligns bearing cups during installation.
- Eliminates the possibility of damage to the needle bearing.

**No. 5192** Heavy-Duty Bearing Cup Installer.



### Differential Housing Spreader

Removing and installing differential ring gear assemblies is typically a difficult, time-consuming chore - that is, unless you're using this differential housing spreader. This device uses mechanical screw power to spread the housing, allowing easy removal of the differential assembly while eliminating damage often caused by makeshift methods.

- Works on Dana axle models 30 through 70.

**No. 7071** Differential housing spreader.

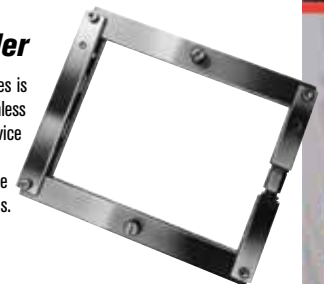

### Truck Clutch Alignment Tools

- These 10-spline shafts are available in the most popular sizes.
- Constructed of a lightweight fiberglass-reinforced nylon body that won't hang up in the clutch disc splines.
- Designed for perfect fit to the spline of the clutch disc...easily supports heavy pressure plates.

To order individually use item number listed below.

**No. 5070** 1-1/2" O.D., 30 mm pilot.

**No. 7072A** 1-1/2" O.D., 1" pilot.

**No. 7073A** 1-3/4" O.D., 1-1/4" pilot.

**No. 7074A** 2" O.D., 1-1/4" pilot.

**No. 7480** 1-3/4" O.D., 1" pilot.

**No. 5029** 2" O.D., 1-1/4" pilot.

**No. 5030** 1-3/4" O.D., 1-1/4" pilot.



### Truck Clutch Adjustment Gauge Set

- Works on manual and self-adjusting pull-type heavy-duty clutches.
- Quickly checks 1/8" clutch pedal free play, and verifies the 1/2" minimum release bearing travel.

**No. 5035** Truck Clutch Adjustment Gauge Set.

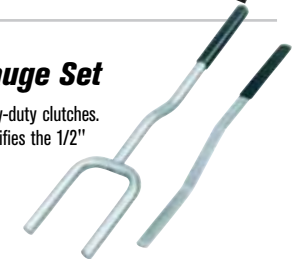

### HD Clutch Adjusting Wrench

- Used for the internal adjustment of Spicer angle-spring and multiple-lever clutches.

**No. 7028** Heavy-Duty Clutch Adjusting Wrench.



### Clutch Service Set

- Designed for Spicer heavy-duty clutches, the nine tools in this set help with a variety of jobs, from clutch installation and removal to flywheel drive-pin installation to clutch adjustment.
- Includes handy plastic carrying case.

**No. 5043** Clutch Service Set.



### Spicer® U-Joint Service Set

- Services Spicer 1600/1610 – 1880 series U-joints; and Rockwell 16N, 17N, 18N, and 1710 series U-joints.

**No. 7057** Spicer U-Joint Service Set.



### Self-Adjusting Clutch Rotating Tool

- This handy tool replaces self-adjuster mechanism on Spicer self-adjusting clutches, allowing you to manually adjust them with a wrench or socket.

**No. 5044** Clutch Rotating Tool.



### Truck Transmission Bearing Service Set

The set is designed to help you remove input shaft bearings and countershaft bearings, in both the main and auxiliary boxes of heavy-duty Fuller transmissions. It will also remove end yokes from 1600/1610-1810 series transmissions. The puller delivers 10 tons of mechanical power— essential force for working on big gearboxes.

- Works on Fuller twin-countershaft transmissions: 125, 600, 660, 900, 9500, 1100, 12500, 12600, 13000, 14600, 15600, and 8600 series, 910-913, 915, and 9513.

**No. 7070A** Truck transmission bearing service set.

**No. 7075** Transmission output shaft end yoke remover

**No. 7207** Collet only.

### Slack Check

This tool enables you to quickly check the brake adjustment on class 7 and 8 trucks and trailers having S-cam brakes. It features a sturdy, four-position handle to provide the leverage you need at the proper angle.

- Works on manual or automatic slack adjusters.

**No. 5052** Slack check.



### Brake Anchor Pin and Bushing Service Set

With the No. 5038, there's no need to remove the bearing hub assembly just to replace the pins and bushings on 16-1/2" S-cam trailer and tractor "Q" brake systems. Much less complicated and time consuming!

- Special tooling and our C-frame press get you past the hub assembly, so you can do the job quickly and professionally without damaging other parts.
- Includes everything needed for removal and replacement.
- Tooling is available separately for the tech who already owns the 7248 C-frame press.

**No. 5038** Brake anchor pin and bushing service set includes C-frame press and tooling in a plastic storage case.



### Wheel Tipper

This heavy-duty wheel tipper makes handling those hard-to-manage truck tires easy, in or out of the shop. To use the wheel tipper, simply deflate the tire and break the bead, then hook the wheel tipper to the rim of the wheel. With both hands on the wheel tipper, pull it towards you. The wheel tipper makes an otherwise tough task effortless.

- Designed for both aluminum and steel wheels.
- Reduces back strain when tilting deflated wheel assemblies for maintenance – won't damage wheel rim.

**No. 5082** Wheel Tipper.

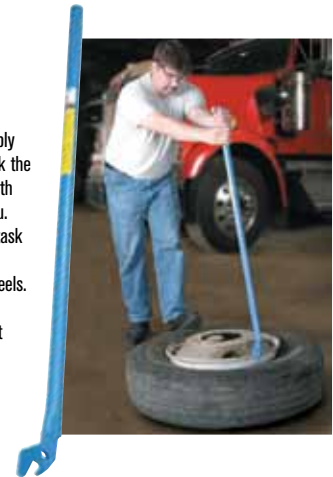



### Slack Adjuster Pullers

These pullers will yank even the most corroded slack adjuster off the S-cam— and do so in just a fraction of the time needed with “heat and beat” methods. Plus, they won’t damage components. Both pullers have a rugged forcing screw and cast steel body. Puller No. 5055 fits many manual types, and the No. 5056 works on most Rockwell, Haldex, Gunite, and Bendix automatic adjusters.

- No. 5055** Manual slack adjuster puller.
- No. 5056** Automatic slack adjuster puller.



### Air Brake Service Kit

This kit has the tools needed to remove slack adjusters and push-rod clevis pins used in the S-cam brake systems of class 7 and 8 vehicles.

- Works on manual or automatic slack adjusters.
- Includes Nos. 5055 and 5056 slack adjuster pullers, 5057 brake clevis pin press, and a plastic storage case.

**No. 5054** Air brake service kit.



### Axle Stud Cone Pliers

- Specially designed pliers gives you the leverage needed to expand the cone and remove it from the stud for axle removal.

**No. 7077** Axle Stud Cone Pliers.

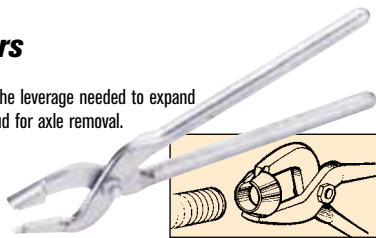

### Forcing-Screw C-Press

- This versatile forcing-screw C-press has many uses.
- Safely remove and replace automotive universal joints with needle bearings, including GM plastic pin CV U-joints.
- Remove stubborn and rusted brake anchor pins up to 1-1/4" from spiders on heavy-duty vehicles.

**No. 7248** Forcing-Screw C-Press.

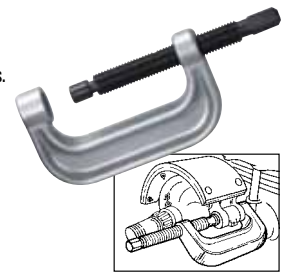

### Hub Oil Seal Puller

- Eliminates bearing and hub damage that can occur when a punch and hammer is used to remove the seal.
- Extra long 28" handle provides leverage, and the unique pulling head design quickly and easily removes the seal in one piece.
- This tool will last a lifetime! Built from the highest quality heat-treated steel.
- Removes hub seals on trailer and truck axles including truck steering axles.

**No. 5085** Hub Oil Seal Puller.



### Heavy-Duty Truck Brake Spring Pliers

- 26-1/4" length gives the leverage you need.
- Large jaw opening allows service of widest shoes.
- Has replacement tip.

**No. 7069A** Heavy-Duty Truck Brake Spring Pliers.

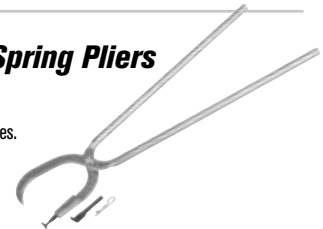

### S-Cam Air Brake Spring Tool

- Safely replace brake shoes on heavy-duty tractors and trailers.
- Simply hook the retaining spring loop and press down. Lever action against the axle.

**No. 5081** S-Cam Air Brake Spring Tool.  
**No. 314548** Replacement Hook Kit.



9851

### Wheel Bearing Locknut Sockets (8 pt.)

- No. 9851** 18 wheel bearing locknut sockets (8 pt.) with tool board. Wt., 53 lbs., 14 oz.
- No. 62909** Display board only. Wt., 6 lbs., 11 oz.

No.	Qty.	Description	No.	Qty.	Description
1903	1	Locknut socket (2-3/8")	1925	1	Locknut socket (3-3/4")
1905	1	Locknut socket (2-9/16")	1927	1	Locknut socket (3-13/16")
1907	1	Locknut socket (3")	1929	1	Locknut socket (2-5/8")
1909	1	Locknut socket (3-1/4")	1930	1	Locknut socket (2-7/8")
1911	1	Locknut socket (3-1/2")	1931	1	Locknut socket (3-5/8")
1913	1	Locknut socket (3-7/8")	1933	1	Locknut socket (2-7/8")
1917	1	Locknut socket (4-3/8")	1935	1	Locknut socket (3-1/8")
1919	1	Locknut socket (4-7/8")	1937	1	Locknut socket (2-3/4")
1924	1	Locknut socket (3-3/8")	1938	1	Locknut socket (4-1/2")



9852

### Wheel Bearing Locknut Sockets

- A selection of popular sizes in 6- or 8-point.
- No. 9852** 12 wheel bearing locknut sockets and tool board. Wt., 34 lbs., 4 oz.
- No. 62910** Display board only. Wt., 5 lbs., 3 oz.

No.	Qty.	Description	No.	Qty.	Description
1904	1	Locknut skt. (2-9/16" hex)	1915	1	Locknut skt. (4-1/8" hex)
1908	1	Locknut skt. (3-1/4" hex)	1921	1	Locknut skt. (2-1/2" hex)
1909	1	Locknut skt. (3-1/4" 8 pt.)	1922	1	Locknut skt. (2-5/8" hex)
1910	1	Locknut skt. (3-1/2" hex)	1923	1	Locknut skt. (2-3/4" hex)
1913	1	Locknut skt. (3-7/8" 8 pt.)	1928	1	Locknut skt. (2-9/16" hex rounded)
1914	1	Locknut socket (4" hex)	1932	1	Locknut skt. (2-7/8" hex)

## Locknut Sockets

- These high-grade truck wheel bearing locknut sockets are made of high-strength steel and resist rounding out.
- For manual use only, impact wrench voids warranty.
- Order individually by item number.



Item	Drive	Point	Opening Size
1901	3/4"	(6 pt.)	2-3/32"
1902	3/4"	(6 pt.)	2-3/8"
1903	3/4"	(8 pt.)	2-3/8"
1904	3/4"	(6 pt.)	2-9/16"
1905	3/4"	(8 pt.)	2-9/16"
1906	3/4"	(6 pt.)	3"
1907	3/4"	(8 pt.)	3"
1908	3/4"	(6 pt.)	3-1/4"
1909	3/4"	(8 pt.)	3-1/4"
1910	3/4"	(6 pt.)	3-1/2"
1911	3/4"	(8 pt.)	3-1/2"
1912	3/4"	(6 pt.)	3-7/8"
1913	3/4"	(8 pt.)	3-7/8"
1914	3/4"	(6 pt.)	4"
1915	3/4"	(6 pt.)	4-1/8"
1916	3/4"	(6 pt.)	4-3/8"
1917	3/4"	(8 pt.)	4-3/8"
1918	3/4"	(6 pt.)	4-7/8"
1919	3/4"	(8 pt.)	4-7/8"
1920	3/4"	(6 pt.)	2-1/4"
1921	3/4"	(6 pt.)	2-1/2"
1922	3/4"	(6 pt.)	2-5/8"
1923	3/4"	(6 pt.)	2-3/4"
1924	3/4"	(8 pt.)	3-3/8"
1925	3/4"	(8 pt.)	3-3/4"
1926	3/4"	(6 pt.)	3-3/4"
1927	3/4"	(8 pt.)	3-13/16"
1928*	3/4"	(6 pt.)	2-9/16"
1932	3/4"	(6 pt.)	2-7/8"
1933	3/4"	(8 pt.)	2-7/8"
1934	3/4"	(6 pt.)	3-1/8"
1935	3/4"	(8 pt.)	3-1/8"
1936*	3/4"	(6 pt.)	2-3/8"
1937	3/4"	(8 pt.)	2-3/4"
1938	3/4"	(8 pt.)	4-1/2"
1939	3/4"	(6 pt.)	5-1/4"
1940	3/4"	(8 pt.)	4-1/8"
1941	3/4"	(8 pt.)	4-13/16"

\*Fits special "rounded" hex nut found on Dana axles of some Ford trucks. The following are metric size wheel bearing locknut sockets.

1950M	3/4"	(6 pt.)	54 mm
1951M	3/4"	(6 pt.)	55 mm
1952M	3/4"	(6 pt.)	60 mm
1953M	3/4"	(6 pt.)	70 mm
1954M	3/4"	(6 pt.)	71 mm
1955M	3/4"	(6 pt.)	80 mm
1956M	3/4"	(8 pt.)	82 mm
1957M	3/4"	(8 pt.)	90 mm
1958M	3/4"	(8 pt.)	94 mm
1959M	3/4"	(8 pt.)	106 mm
1960M	3/4"	(8 pt.)	110 mm
1961M	3/4"	(8 pt.)	120 mm
1962M	3/4"	(8 pt.)	100 mm

## Lug Nut Cap Remover

Chrome-plated lug nut caps found on many heavy-duty trucks and trailers can be tough to remove, and they're easily damaged if you pry them off or use an ordinary cap remover. This tool avoids those problems. It is ruggedly built and features specially coated jaws that won't slip off the caps, no matter how much squeezing force you apply.

- Features cushioned handles.

**No. 5047** Lug nut cap remover.



## Truck Pinion Sockets

We've designed and built these sockets to have the proper clearance for yoke and locknut assemblies on a variety of truck transmissions and differentials. The sockets have 3" of usable depth and are 4" long. Using the right tools saves time and effort and eliminates the need to destroy standard sockets by grinding them down to fit tight pinion clearances.

- For manual use only, impact wrench voids warranty.
- To order individually use item number listed below.

**No. 9814** Comes complete with tool board and six sockets, 1975 thru 1980 listed below (No. 1981 is not included).

Item	Drive	Point	Opening Size
1975	3/4"	(6 pt.)	2"
1976	3/4"	(6 pt.)	2-1/8"
1977	3/4"	(6 pt.)	2-1/4"
1978	3/4"	(6 pt.)	2-3/8"
1979	3/4"	(6 pt.)	2-5/8"
1980	3/4"	(6 pt.)	2-3/4"
1981	3/4"	(6 pt.)	2-1/2"



## Budd Wheel Socket Set (5 piece)

- One each of the sockets listed below comes in a convenient storage box.
- The metric sizes work on the import truck Budd wheels, and the 1-1/2" hex is for American-made trucks with dual rear wheels.
- Extra-deep design lets you remove both nut and stud with just one socket.
- Useable with a 1" square drive impact wrench.
- **To order individually use item number listed below.**

**No. 1944** Budd Wheel Socket Set comes complete with the five sockets listed below in a molded plastic case.



Individual Item	Drive	Opening Size
1945A	1"	35 mm hex
1946A	1"	38 mm hex
1947A	1"	41 mm hex
1948A	1"	33 mm hex
1949A	1"	1-1/2" hex



9850

## Truck Wheel Bearing Locknut Sockets (6-pt.)

**No. 9850** 21 wheel bearing locknut sockets with tool board. Wt., 54 lbs., 7 oz.

**No. 62908** Display board only. Wt., 5 lbs., 7 oz.

No.	Qty.	Description	No.	Qty.	Description
1901	1	Locknut socket (2-3/32")	1920	1	Locknut socket (2-1/4")
1902	1	Locknut socket (2-3/8")	1921	1	Locknut socket (2-1/2")
1904	1	Locknut socket (2-9/16")	1922	1	Locknut socket (2-5/8")
1906	1	Locknut socket (3")	1923	1	Locknut socket (2-3/4")
1908	1	Locknut socket (3-1/4")	1926	1	Locknut socket (3-3/4")
1910	1	Locknut socket (3-1/2")	1928	1	Lknt. skt. (2-9/16" rounded)
1912	1	Locknut socket (3-7/8")	1932	1	Locknut socket (2-7/8")
1914	1	Locknut socket (4")	1934	1	Locknut socket (3-1/8")
1915	1	Locknut socket (4-1/8")	1936	1	Lknt. skt. (2-3/8" rounded)
1916	1	Locknut socket (4-3/8")	1939	1	Locknut socket (5-1/4")
1918	1	Locknut socket (4-7/8")			

## Sprinter Van Front End Kit

- Eight piece kit contains the tools needed to service lower ball joints on 2004-07 Dodge Sprinter vans: tie rod remover / separator; wheel alignment studs; ball joint remover; driver, receiver, and installing rings.
- Use this kit with OTC No. 6736 C-frame.

**No. 6735** Sprinter Van Ball Joint Kit.



## Universal Bearing Cup Installer

This handy, adjustable tool is designed to install wheel-bearing cups in a wide range of heavy-duty axles. Simply adjust and lock the jaws to the cup I.D., slip on the new cup, set it in the bore, and drive it in with a hammer. The tool helps eliminate the damage caused by makeshift methods.

- Works on axles from 11,000 to 50,000 lb. capacity.
- Adjusts to fit 3-5/8" to 6-1/2" O.D. bearing cups, which adds up to as many as 30 individual drivers.

**No. 7180** Universal bearing cup installer.

**No. 52038** Replacement jaw.

**No. 207561** Replacement retaining spring.



## Mack Kingpin Socket

Here is a socket that makes life a little easier for anyone who works on Mack trucks. Designed for 1/2" square drive ratchet or breaker bar, the socket fits the slotted adjusting screw in tapered kingpins used on most Mack front axles (12,000 to 20,000 lbs.).

**No. 5053** Mack kingpin socket.



## Truck Front Leaf Spring, Pin and Bushing Service Set

- Delivers 10 tons of hydraulic force to remove and install truck front spring eye pin and bushing assemblies quickly and easily.
- Services bushings with diameters from 1-1/4" through 1-7/8", pin diameters from 7/8" through 1-1/8". Handles all popular OE and aftermarket components, including Horton pin and bushing assemblies.
- Services bushing assemblies, in many cases without removing leaf spring hangers and spring assemblies from the vehicle.
- All accessories are included except the hydraulic hand pump, which must be purchased separately.

**No. 5080** Truck Front Leaf Spring, Pin & Bushing Service Set.



## Heavy-Duty Power Steering Pump Analyzer

- There is only one way to troubleshoot problem components in a heavy-duty power steering system: a flow and pressure reading meter. OTC's new No. 5079 measures both: 1 to 10 gallons oil flow and up to 3,000 psi of pressure.
- When connected in line, this universal analyzer will isolate the failed components in just minutes. There is no wasted time with trial and error methods.
- The set is complete with high pressure hoses, 9/16"-18 standard fittings, and quick disconnect couplers to handle Eaton/Vickers, TRW, Ross, and Shepard power steering systems.

**No. 5079** Heavy-Duty Power Steering System Analyzer with hoses, fittings, and couplers in a handy storage case.

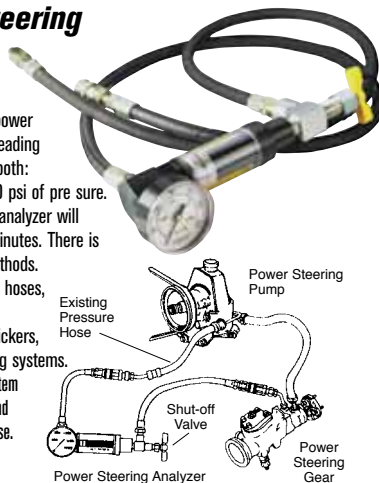

## Truck Kingpin and Brake Anchor Pin Pusher

- 30 tons of hydraulic force replace torch and sledgehammer methods.
- Includes precision tooling, hydraulic pump and ram.
- Accommodates kingpins of 7/8" to 2" dia. and 11-1/4" in length.
- Works on many models of trucks and buses.

**No. 4240** Complete Kingpin and Anchor Pin Pusher Set. Includes No. 4002 hydraulic hand pump, No. 9767 hose, No. 9798 hose-half coupler, No. 4121 Power Twin 30-ton ram, and No. 29424 anchor pin adapter.

**No. 4241** Kingpin and Anchor Pin Pusher with Anchor Pin Adapter only.

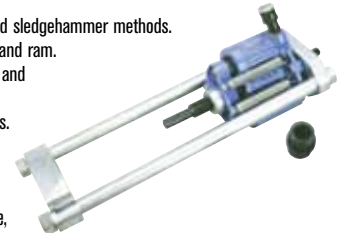

## Diesel Glow Plug Removal Tool

- Removes damaged, stuck-in glow plugs on diesel engines without having to remove cylinder head, saving hours of service time!
- When glow plug tip is melted and plug cannot be removed without breaking it off, this tool is the only answer.
- Tool includes 10 mm and 12 mm split nuts that provide added threads for pulling. One of three furnished spacers is installed under split nut to give a solid base for extraction without breaking glow plug off. Split nut is held with a wrench as the glow plug is unscrewed from the head.
- Services diesels in popular 3/4- and 1-ton pickups, import diesel, ag, and construction vehicles.
- Comes in a plastic storage case.

**No. 6005A** Includes 222888-10 mm and 222887-12 mm split nuts, three spacers (3/16", 1/4", 5/16"), plastic storage/organizer case and instructions.



## Manual Sleeve Puller Set

- This manually operated, screw-powered device removes cylinder sleeves from most truck, bus, and tractor engines.
- Adapter plates (not included in the set) accommodate a wide range of bore sizes. See your representative for details.
- The puller enables one technician to handle sleeve-pulling tasks.
- Not recommended for Mack engines.

**No. 1200** Manual Sleeve Puller Set.



## Cummins Water Pump Pulley Tool

This heavy-duty tool is designed to remove or install water pump pulleys on Cummins L10 and M11 engines, 1991 and newer. The installer has a rugged thrust bearing that allows for friction-free pulley installation without damaging pump components.

**No. 5071** Cummins water pump pulley tool.



## Charged Air Cooler Tester

- Connected to the cooler radiator, this is the easy way to find air leaks in charged air cooling systems on class 7 and 8 trucks.
- Quick disconnect air fittings work on all 3", 3-1/2", and 4" cooler hoses.

**No. 5039** Charged Air Cooler Tester.



### 17-1/2 Ton Hydraulic Sleeve Puller Set

- This hydraulic operated, screw-powered device removes cylinder sleeves from most truck, bus, and tractor engines.
- Adapter plates (not included in the set) accommodate a wide range of bore sizes. See your representative for details.
- The puller enables one technician to handle sleeve-pulling tasks.

**No. 1202** – 17-1/2 Ton Hydraulic Sleeve Puller Set.



### Sleeve Puller for Wet-Type Sleeves

This tool will remove cylinder sleeves faster than ordinary pullers because it requires very little setup time. Cone adjustment positions the puller jaws quickly, locking bar is tightened. To aid in breaking "frozen" sleeves loose, adjustable bridge is positioned on the cylinder block and the bearing-mounted forcing nut is tightened. Next, bridge is removed and slide hammer assembly is attached. With a few sharp hammer blows, sleeve is pulled. In most cases, job time will average less than two minutes per cylinder.

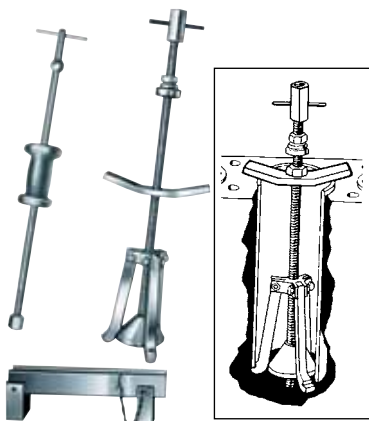

- The puller features a 5 lb. slide hammer to help bust loose even the most stubborn sleeves.
- Special adapters are unnecessary.
- Adjustable jaws fit sleeves 3" to 6-1/2" in diameter.

**No. 1205** Sleeve Puller for Wet-Type Sleeves with 5 lb. slide hammer assembly.

### Diesel Compression Tester with Adapters

This easy-to-use compression tester is designed for light- and medium-duty diesel engines equipped with glow plugs. A dual-reading gauge, featuring a push-button release valve, measures compression to 1000 PSI and 7000 kPa. The hose end has quick disconnect fittings. The tester comes with glow plug and nozzle adapters in a handy storage case. Tester services these engines:

- Cummins B and C
- Navistar DT466/DT360
- Ford/Navistar 6.9L & 7.3L
- Detroit 6.2L & 6.5L
- Hino diesel and Mitsubishi Fuso truck engines

**No. 5020** Diesel compression tester with adapters.

**No. 5021** Universal diesel engine compression gauge.

**No. 304802** Replacement gauge.



5020



5021

### Nozzle-Tester Adapter Set

This is our universal adapter set for testing injection nozzles on the most popular automotive, agricultural, and construction diesel engines. The set has 17 adapters that connect to our No. 4200 Nozlrater testing unit.

- Includes handy metal storage box.
- 23622– used on 1989–95 Cummins 5.9L, 1983–94 Ford 6.9L and 7.3L.
- 23623– used on 1996–2000 Cummins 5.9L and Navistar 6.6L and 7.8L.

**No. 4201** Nozzle-tester adapter set.



### Fuel Injector Nozzle Puller

We've designed this puller to remove the pencil-type fuel injector nozzles used in many agricultural and construction engines. The slide hammer action gives a straight, even pull without damaging components.

- Works on Case, Caterpillar, GM, John Deere, Waukesha, and White diesel engines.

**No. 7121** Fuel injector nozzle puller.



### Nozlrater Diesel Injector Nozzle Tester

The Nozlrater tester enables you to check for leakage, popoff pressure, spray pattern, and chatter. This tool will accommodate a wide range of injectors. We also offer adapters so you can troubleshoot nozzles used in popular automotive, agricultural, and construction engines. Nozlrater features a rugged, lightweight reservoir that holds 7/10 of a gallon of fuel. It is equipped with a replaceable 2-micron filter. The large, dual-scale, high-pressure gauge is protected by a guard and includes an indicator needle to record maximum pressure reached.

- Not designed for Cummins or Detroit injectors.

**No. 4200** Nozlrater diesel injector nozzle tester. 5000 PSI maximum pressure capacity.



### Davco Diesel Filter Wrenches

- Found on Caterpillar, Cummins, Detroit Diesel, International, Mack, Mercedes-Benz, Volvo and other engines.
- Durable, stainless steel construction.
- Precise, laser-cut angles.
- Opens vent cap also.
- Soft, ergonomic handle.

**No. 6914** Fits Davco Diesel filter models, 232-233-234.

**No. 6915** Fits Davco Fuel filters 382 & 384.

### Cummins Diesel Fuel Injector Remover Kit

- Kit contains a fuel injector connector tube remover and fuel injector puller. The fuel injector connector tube must be removed before pulling the injector, or both will be damaged.
- Application: 1998-1/2–2002 Dodge pickups and vans with 5.9L 24-valve Cummins diesel turbo engine.

**No. 6069** Cummins Diesel Fuel Injector Remover Kit.





## Ford Injector Remover/Installer Kit

- Removes and installs injectors without damaging the injector or cylinder head.
- Application: 1994-2003 Ford 3/4- and 1-ton trucks, Super Duty trucks, and vans with 7.3L direct-injected turbocharged (DIT) diesel engine.

**No. 6067** Ford Injector Remover/Installer kit.



## Master Cummins Diesel Fuel Injection Test Kit

- Includes the fittings and gauge needed to check fuel pressure, fuel volume, and fuel restrictions from the delivery pump to the injection pump.
- Application: 1988-98 Dodge pickups and vans with 5.9L 12-valve, and 1998-1/2-2003 5.9L 24-valve Cummins diesel engines.

Contents:

- No. 6077** Quick-disconnect banjo fitting (M14 x 1.5 external).
- No. 7915** Two fuel injection quick-coupler adapters.
- No. 7426** Quick-disconnect banjo fitting (M12 x 1.5 external).
- No. 223336** Gauge assembly.
- No. 6082** Fuel volume test adapter.
- No. 6078** Diesel fuel inlet restriction test adapter.
- No. 6080** Master Cummins Diesel Fuel Injection Test kit.



## Cummins Diesel Fuel Inlet Restriction Test Adapter

- Adapter is used to perform a vacuum test on the transfer pump; excessive vacuum reading indicates a fuel inlet restriction.
- Application: 1988-95 Dodge trucks and vans with 5.9L 12-valve Cummins diesel engine. Included in OTC set No. 6080.

**No. 6078** Cummins Diesel Fuel Inlet Restriction Test Adapter.

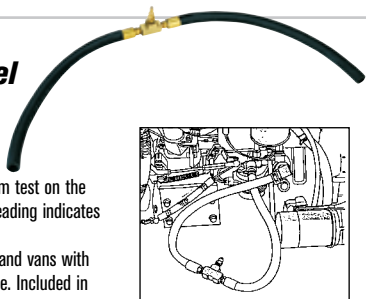

## Compressor Drive-Gear Coupling Puller

Here's the solution for removing the coupling from the Cummins Compact and Bendix air compressors found on many Cummins 855 cubic inch engines. The split collet design fits over the coupling, and mechanical force does the work.

- Works on compressors with 1-3/4" O.D. shaft.

**No. 7119** Compressor drive-gear coupling puller.



## Power Twin® Ram and Pump Set

Center-hole feature permits extending adjusting screws, cables, puller screws, etc., straight through the ram.

- This spring return unit is compact and lightweight.
- Ideal for jobs having restricted working space.

**No. 4180** Set includes 4120 17-1/2 ton, 2" stroke single-acting hydraulic ram; 4002 pump; 9650 gauge; 24815 tee; 9767 hose; and 9798 hose half coupler.

## 10-Ton Collision Repair Set

- Exert hydraulic force just where it's needed to lift, spread, bend, or straighten. Handles the high-force jobs you face daily in trailer maintenance or other applications.
- Includes reliable components including 10-ton, 10-1/8" stroke hydraulic ram; air/hydraulic pumping unit; hydraulic hose; four snap-together extension tubes; extension tube coupling; serrated saddle; flat base; 90° wedge head; flex head; storage case.
- All set components are covered by OTC Lifetime Marathon Warranty®.

**No. 5086** 10-ton Collision Repair Set.

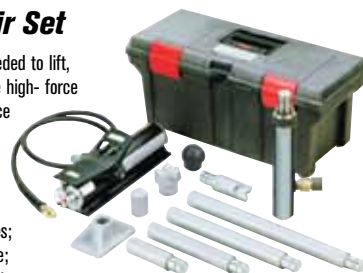

## Four-In-One™ Puller Set, 7-Ton Capacity

- With the parts included in the PA7 you can quickly assemble a 2/3-jaw puller with standard or long reach.
- 7-ton capacity, the max. reach of 8-3/4", and max. spread of 11" make it ideal for hundreds of pulling jobs.

**No. PA7** Four-In-One Puller Set, 7-ton cap. Standard jaw max. reach: 5". Max. spread: 10-1/2". Long jaw max. reach: 8-3/4". Max. spread: 11".



## Jimmy Bars

We've forged these bars from chrome alloy steel, then heat-treated them to resist bending and breaking.

- No. 7168** 7/8" Diameter, 30" Long.
- No. 7420** 7/8" Diameter, 46" Long.
- No. 7421** 1" Diameter, 54" Long.



## Handled Pry Bars

- Black chrome striking cap allows hitting the bar without handle damage.
- Ergonomic handle - dual durometer composite handle for user comfort; reduces hand fatigue.
- Polished tip with black oxide finish.
- Long-life finish resists rust and wear during use.
- OTC Lifetime Warranty.

**No. 8203** 3-piece handled pry bar set in gray molded tray. Includes 12", 18", and 24" sizes.

**No. 8206** 6-piece handled pry bar set in a molded tray. Includes 8", 12", 18", 24", 32", and 36" sizes.

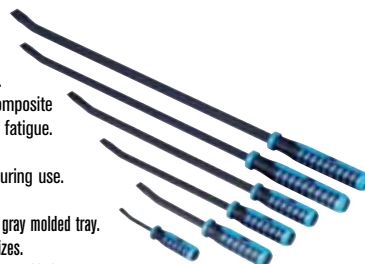

## Torque Wrenches

- Clicks when you reach the torque setting.
- No. 7379** Torque Wrench, 100-600 ft. lbs. Ratchet-style head, 3/4" sq. drive, 42-1/4" length.
- No. 7378** Torque Wrench, 50-250 ft. lbs. Ratchet-style head, 1/2" sq. drive, 19-3/8" length.

## Smoke Check 1667 Diesel Emission Tester

- Completely portable. No warm-up time needed.
- Digital LCD screen walks you through each step. When testing is complete, a printout of results is produced for verification.
- The partial flow meter clips inside any smokestack; testing can be performed in any weather.
- Meets the latest SAE J1667 specifications.



- No. RM1020C** Smoke Check 1667 Diesel Smoke Opacity Tester. Includes partial flow meter, base unit with hand-held display, built-in printer, ambient sensors, two battery chargers one for vehicle or shop, 20 ft. cable, telescoping rod, spring clamp, neutral density filter, and sensor head case.
- No. OTC3020C** Standard meter listed above with OIL/RPM software and accessories. These options are required for state approval testing in New York and New Jersey.

## Universal Outside Thread Chaser

- Precision dies restore threads to their original condition. Includes 6 dies.
- The capacity is from 1-1/4" to 5" O.D.

**No. 7402** Universal Outside Thread Chaser.



## Bearing Splitter Combo Pack

- This combo pack contains four of OTC's most popular bearing splitters, plus a pulley pulling attachment.
- A rugged organizer case is included.
- Contains: No. 1121 bearing splitter with 15/16" max. spread and 1/4" min. spread, No. 1122 bearing splitter with 2" max. spread and 1/8" min. spread, No. 1123 bearing splitter with 4-5/8" max. spread and 1/2" min. spread, No. 1130 bearing splitter with 9" max spread and 1/2" min. spread, and No. 679 pulley pulling attachment with a 5-7/8" max. and 1-3/4" min. spread.

**No. 1183** Bearing Splitter Combo Pack.



## Pilot Bearing Puller

- Designed to pull flywheel pilot bearings in close quarters where a slide hammer cannot be used.
- Operates on many models with engine in chassis.
- Capacity is 7/8" to 2" with I.D. reach of 1".

**No. 7319** Pilot Bearing Puller.



## LeakTamer Plus EVAP

- Easy, effective, versatile tool to help technicians diagnose EVAP trouble codes on domestic and import cars and light trucks.
- Uses UltraTraceUV™ technology – the only OEM-approved dye available.
- Works with nitrogen or shop air to meet all OEM test requirements.
- Equipped with Auto-correct EVAP Pressure.
- No manual flow control valve to shut off.
- A truly versatile unit for testing a wide range of systems.
- Uses existing OTC LeakTamer accessories.

**No. 6521** LeakTamer Plus EVAP.



## Engine Preluber Kit

- Ensures oil is present to internal engine components on the first start of a new or rebuilt engine, or after major engine work is performed.
- Required to prime the oil pump and fill the oil galleries and internal engine components with clean, new oil.
- Connects to engine oil system at the oil pressure sensor on a variety of domestic and import engines.
- Oil pressure sensor adapters included.

**No. 6492** Engine Preluber Kit.



## Hendrickson Primaax Quick Alignment Socket

- Used to adjust axle alignment on the Primaax air suspension.
- Works on Primaax models 230, 460, and 690 rear suspensions.
- Hendrickson – Approved tool.

**No. 1767** Hendrickson Primaax Quick alignment socket.



## Hendrickson PRIMAAAX® Quick Wrench

- Hendrickson – Approved tool.
- Used to torque cross tube end cap bolts and longitudinal torque rod top pad bolts.
- Reduces maintenance time by eliminating the need to remove the tires to gain access to the end cap bolt.
- Use with the following Hendrickson PRIM AAX suspensions:
  - Type A - PAX 230/460/690 and FMX 240/480 with 8-1/2" Ride Height
  - Type B - PAX 230/460/690 with 10" Ride Height.

**No. 1768** Hendrickson PRIMAAAX® Quick Wrench.



## Hendrickson Bar Pin Adapter Set

Servicing bar pin end bushings used on Hendrickson equalizing beam tandem truck suspensions requires the use of special tooling. OTC's No. 1757 adapter set is used with the beam removed from the truck, and in conjunction with OTC No. 51100 press plate and a 100-ton hydraulic shop press. The 1757 set, which replaces the No. 1747 set, includes an adapter for installing bushings in older forged beams as well as the fabricated beams introduced in 1999.

To remove bushings, use OTC's previously introduced No. 302030 removing adapter and No. 206457 press adapter, both of which may be ordered separately. Reinstall bushings following procedures recommended by the suspension manufacturer.

**No. 1757** Hendrickson Bar Pin Adapter Set.



## Hendrickson Suspension Bar Pin End Bushing Adapter Set

You can now remove and install worn end bushings on the Hendrickson new style bar pin end bushings without removing the equalizing beam from the vehicle.

The No. 1749 works in conjunction with OTC's No. 1741 and No. 1742 80-ton portable service equipment to do the job quickly, using procedures recommended by the manufacturer.

**No. 1749** Hendrickson Suspension Bar Pin End Bushing Adapter Set.

For use with OTC No. 1741 and No. 1742 80-ton portable hydraulic service sets.



## Hendrickson Press Tooling Set

**For 340 and 380/440 series suspensions. Use with a shop press.**

This set is the answer for replacing center and end bushings on Hendrickson 340 and 380/440 series suspensions. The 1764 is for use with a 100-ton or larger hydraulic press. The press plate sits on the press bolster to provide a level, cradle-like surface for the beam to rest on during pressing.

**No. 1764** Hendrickson Press Tooling Set.

